



MTDP20



MTDP20C

MTDP07



MTDP07C

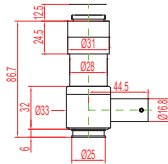

MTDP10



MTDP10C

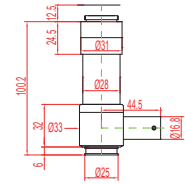

MTDP20

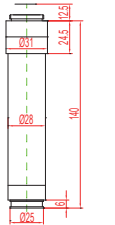

MTDP20C

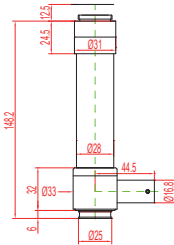

MTDP30



MTDP30C

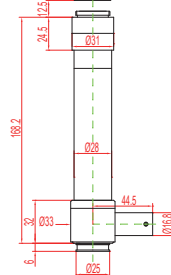

MTDP40



MTDP40C

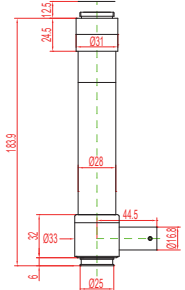

MTDP50

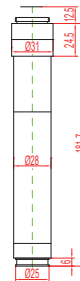

MTDP50C

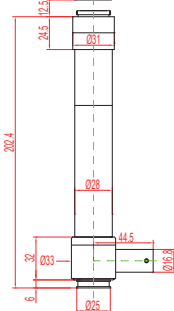

MTDP60



MTDP60C

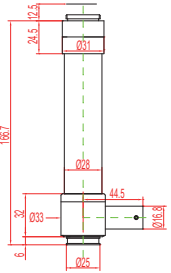

MTDP80



MTDP80C

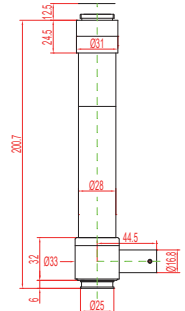

### 光学参数 Optical specifications

表1: 配1X前组物镜时的参数 (工作距离: 82mm)

Form1: In the condition of matched with 1X front-end objectives(WD:82mm)

| 镜头型号<br>Model | 物镜倍数<br>Objective | 总放大倍数 / Total Mag. |          | 视场<br>FOV(mm) |
|---------------|-------------------|--------------------|----------|---------------|
|               |                   | 1/3"、9"            | 1/3"、17" |               |
| MTDP07        | 0.7X              | 28X                | 42X      | 6.9X5.1       |
| MTDP07C       |                   |                    |          |               |
| MTDP10        | 1.0X              | 40X                | 60X      | 4.8X3.6       |
| MTDP10C       |                   |                    |          |               |
| MTDP20        | 2.0X              | 80X                | 120X     | 2.4X1.8       |
| MTDP20C       |                   |                    |          |               |
| MTDP30        | 3.0X              | 120X               | 180X     | 1.6X1.2       |
| MTDP30C       |                   |                    |          |               |
| MTDP40        | 4.0X              | 160X               | 240X     | 1.2X0.9       |
| MTDP40C       |                   |                    |          |               |
| MTDP50        | 5.0X              | 200X               | 300X     | 0.96X0.72     |
| MTDP50C       |                   |                    |          |               |
| MTDP60        | 6.0X              | 240X               | 360X     | 0.8X0.6       |
| MTDP60C       |                   |                    |          |               |
| MTDP80        | 8.0X              | 320X               | 480X     | 0.60X0.45     |
| MTDP80C       |                   |                    |          |               |



表2: 使用不同前组物镜时的参数  
Form2: In the condition of Using different front-end objectives

| 前组物镜<br>Front-end objectives | 项目<br>Items            | MTDP10<br>MTDP10C | MTDP07<br>MTDP07C | MTDP20<br>MTDP20C | MTDP30<br>MTDP30C | MTDP40<br>MTDP40C | MTDP50<br>MTDP50C | MTDP60<br>MTDP60C | MTDP80<br>MTDP80C |
|------------------------------|------------------------|-------------------|-------------------|-------------------|-------------------|-------------------|-------------------|-------------------|-------------------|
| 1X                           | 光学放大倍率<br>Optical Mag. | 1.0X              | 0.7X              | 2.0X              | 3.0X              | 4.0X              | 5.0X              | 6.0X              | 8.0X              |
|                              | 景深DOF $\mu$ m          | 412.4             | 589.1             | 206.2             | 137.5             | 103.1             | 82.5              | 68.7              | 51.5              |
| 0.3X                         | 光学放大倍率<br>Optical Mag. | 0.3X              | 0.21X             | 0.6X              | 0.9X              | 1.2X              | 1.5X              | 1.8X              | 2.4X              |
|                              | 景深 / DOF ( $\mu$ m)    | 4597.7            | 6568.1            | 2298.9            | 459.8             | 1149.4            | 919.5             | 766.3             | 574.7             |
| 0.5X                         | 光学放大倍率<br>Optical Mag. | 0.5X              | 0.35X             | 1.0X              | 1.5X              | 2.0X              | 2.5X              | 3.0X              | 4.0X              |
|                              | 景深 / DOF ( $\mu$ m)    | 1666.7            | 2381.0            | 833.3             | 555.6             | 416.7             | 333.3             | 277.8             | 208.3             |
| 0.75X                        | 光学放大倍率<br>Optical Mag. | 0.75X             | 0.5X              | 1.5X              | 2.3X              | 3.0X              | 3.8X              | 4.5X              | 6.0X              |
|                              | 景深 / DOF ( $\mu$ m)    | 740.7             | 1111.1            | 370.4             | 241.5             | 185.2             | 146.2             | 123.5             | 92.6              |
| 1.5X                         | 光学放大倍率<br>Optical Mag. | 1.5X              | 1.1X              | 3.0X              | 4.5X              | 6.0X              | 7.5X              | 9.0X              | 12.0X             |
|                              | 景深 / DOF ( $\mu$ m)    | 190.5             | 259.7             | 95.2              | 63.5              | 47.6              | 38.1              | 31.7              | 23.8              |
| 2X                           | 光学放大倍率<br>Optical Mag. | 2X                | 1.4X              | 4.0X              | 6.0X              | 8.0X              | 10.0X             | 12.0X             | 16.0X             |
|                              | 景深 / DOF ( $\mu$ m)    | 105.3             | 150.4             | 52.6              | 35.1              | 26.3              | 21.1              | 17.5              | 13.2              |
| 5X                           | 光学放大倍率<br>Optical Mag. | 5X                | 3.5X              | 10X               | 15X               | 20X               | 25X               | 30X               | 40X               |
|                              | 景深 / DOF ( $\mu$ m)    | 16.7              | 23.8              | 8.3               | 5.6               | 4.2               | 3.3               | 2.8               | 2.1               |

表3: 使用不同前组物镜时的参数  
Form3: In the condition of Using different front-end objectives

| 前组物镜<br>Front-end objectives | 1X    | 0.3X  | 0.5X  | 0.75X | 1.5X | 2X   | 5X   |
|------------------------------|-------|-------|-------|-------|------|------|------|
| 工作距离<br>WD(mm)               | 82    | 293   | 175   | 117   | 54   | 35   | 10.1 |
| 分辨率<br>Resolution ( $\mu$ m) | 3.5   | 11.6  | 7     | 4.7   | 2.4  | 1.8  | 0.7  |
| NA                           | 0.097 | 0.029 | 0.048 | 0.072 | 0.14 | 0.19 | 0.48 |