



- 拥有中国品种最齐全的单筒视频显微物镜产品库
- 包括单倍率视频光学系统，单筒斜筒对刀显微镜，双倍率视频光学系统，MTDP无穷远镜头单筒视频光学系统等四大系列
- 有不同放大倍率、各种工作距离、同轴照明、光路90°，180°转折、双倍率等近二百种规格型号
- 用于电子设备、半导体检测、锡点检测、印刷贴纸检测、晶片及液晶显示检测以及类似用途
- MTD 常规设计的接口均为CS接口（定位面至靶面的距离为12.5mm），如需要C接口（定位面至靶面的距离为17.5mm），均可以定制

- ◆ Most complete variety of monocular video microscope objectives in China
- ◆ Single Magnification Video Optical Systems, Lathe tool--setting Inclined Eyetube Microscope, Double Magnification Video Optical Systems, MTDP Infinity Monocular Video Optical Systems
- ◆ Over 200 models which configure different magnification, working distance, coaxial illuminator, optical path turn 90°, 180° double magnification and etc.
- ◆ Applied for inspection and similar purpose on electric equipments, semiconductor, tin, printed stickers, wafer, LCD display.
- ◆ standard CS mount (the distance from the positioning surface to the target surface is 12.5mm), if C mount is needed (the distance is 17.5mm), it can be customized.

产品命名规则 Name Rule

MTD 20 C-185 S A

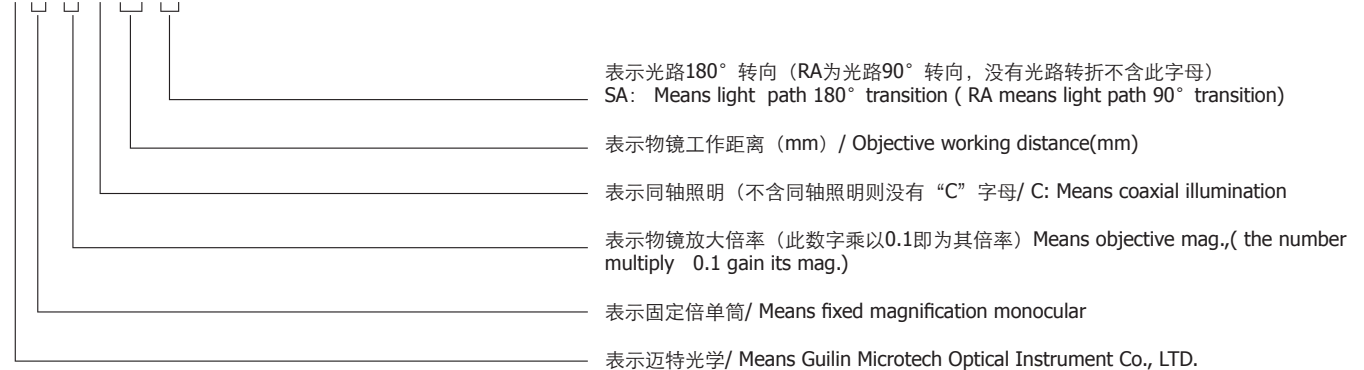

※本系列产品已获得国家专利授权，受相关国家法律法规保护。专利号：ZL 2011 2 0165124.7

This series have obtained national patents, and protected by related national laws and regulations. Patent number: ZL 2011 2 0165124.7

品种最齐全
Complete Variety

倍率固定
Fixed Mag.

接受定制
Accept Customization

MTD01-156

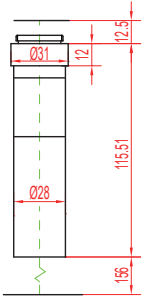

MTD02-140

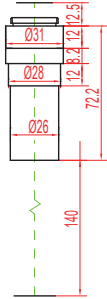

MTD03-100

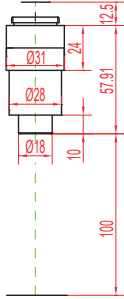

MTD03-125

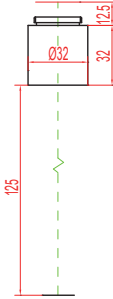

MTD03-170

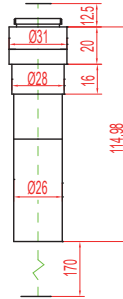

MTD04-100

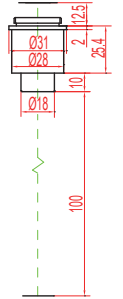

MTD04-150

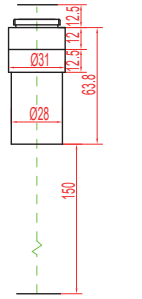

MTD05C-60

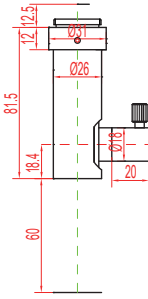

MTD05-150RA

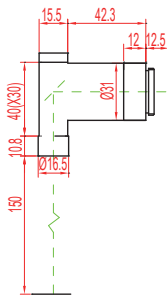

MTD05C-170

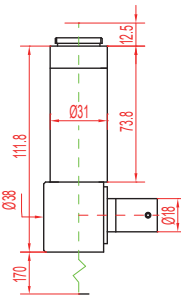

MTD06-55

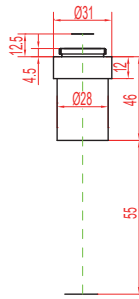

MTD06-150

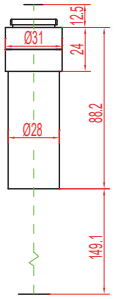

MTD06C-150

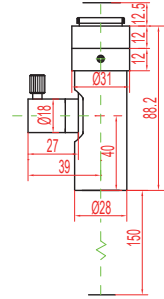

MTD6.5C-70RA

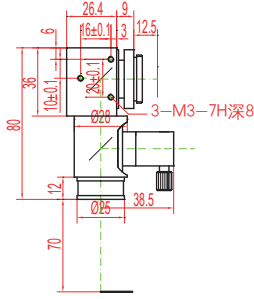

MTD07-75RA

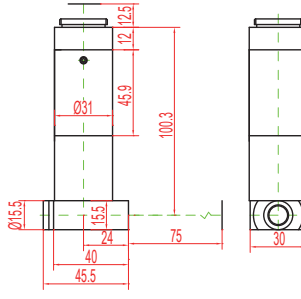

MTD07-100

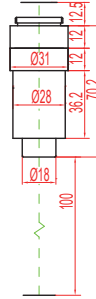

MTD07-110

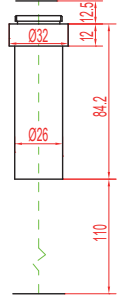

型号 Model	物镜倍数 Objective	工作距离 WD(mm)	总放大倍数 (Total Mag.)		视场 FOV(mm)	数值孔径 NA	景深 DOF	分辨率 Resolution
			1/3"、9"	1/3"、17"				
MTD01-156	0.1X	156	4X	7.2X	48X36	0.008	50mm	42μm
MTD02-140	0.2X	140	8X	14.4X	24X18	0.015	13.5mm	23μm
MTD03-100	0.3X	100	12X	21.6X	16X12	0.037	3.6mm	9.1μm
MTD03-125		125						
MTD03-170		170						
MTD04-100	0.4X	100	16X	28.8X	12X9	0.059	1.7mm	5.8μm
MTD04-150		150						
MTD05C-60	0.5X	60	20X	36X	9.6X7.2	0.035	2.28mm	9.6μm
MTD05-150RA		150						
MTD05C-170		170						
MTD06-55	0.6X	55	24X	43.2X	8X6	0.084	793.6mm	4μm
MTD06-150		150						
MTD06C-150		150						
MTD6.5-70RA	0.65X	70	26X	46.8X	7.4X5.5	0.07	879.1μm	4.79μm
MTD07C-65S	0.7X	65	28X	50.4X	6.9X5.1	0.063	907mm	5.3μm
MTD07-75RA		75						
MTD07-100		100						
MTD07-110	0.7X	110	28X	50.4X	6.9X5.1	0.022	2.59mm	15.25μm

MTD series

品种最齐全
Complete Variety

倍率固定
Fixed Mag.

接受定制
Accept Customization

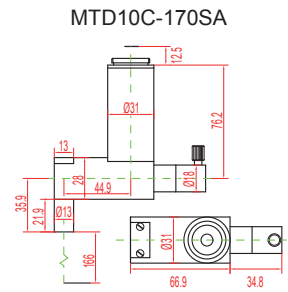
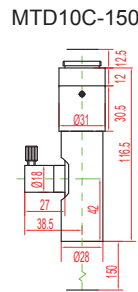
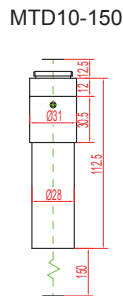
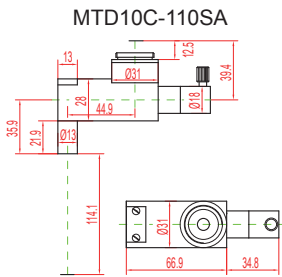
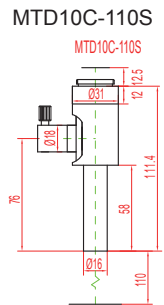
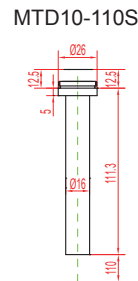
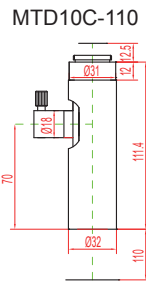
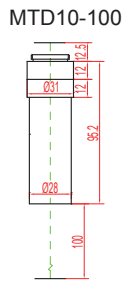
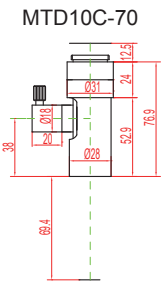
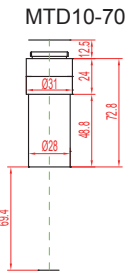
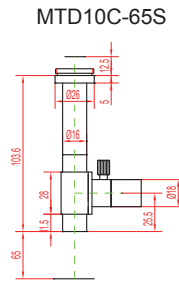
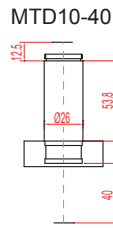
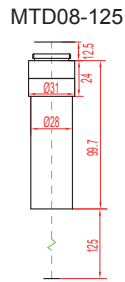
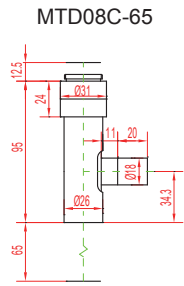

型号 Model	物镜倍数 Obj. Mag.	工作距离 WD(mm)	总放大倍数 (Total Mag.)		视场 FOV(mm)	数值孔径 NA	景深 DOF	分辨率 Resolution
			1/3"、9"	1/3"、17"				
MTD08C-65	0.8X	65	32X	57.6X	6X4.5	0.09	555.5μm	3.73μm
MTD08-125		125				0.046	1.08mm	7.29μm
MTD10-40	1.0X	40	40X	72X	4.8X3.6	0.105	381μm	3.2μm
MTD10-65S		65				0.071	563.4μm	4.72μm
MTD10C-65S		65				0.071	563.4μm	4.72μm
MTD10C-65		65				0.072	555.6μm	4.66μm
MTD10-70		70				0.047	588.2μm	4.9μm
MTD10C-70		70				0.047	588.2μm	4.9μm
MTD10-100		100				0.07	571μm	4.8μm
MTD10C-110		110				0.056	714.3μm	5.9μm
MTD10-110S		110				0.057	701.8μm	5.9μm
MTD10C-110S		110				0.057	701.8μm	5.9μm
MTD10C-110SA		110				0.0525	761.9μm	6.4μm
MTD10-150		150				0.042	635μm	8μm
MTD10C-150		150				0.042	635μm	8μm
MTD10C-170SA		170				0.033	1.21mm	10.2μm

MTD10C-180

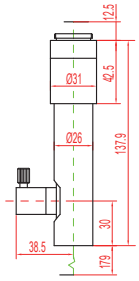

MTD10C-230

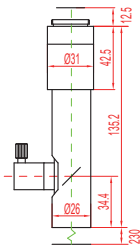

MTD10C-473RA

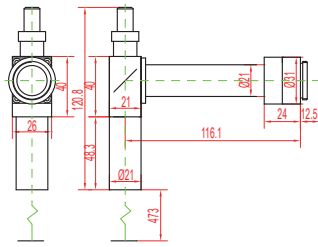

MTD12.5C-60

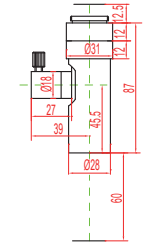

MTD12.5C-70

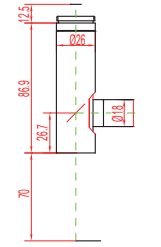

MTD12.5C-70RA

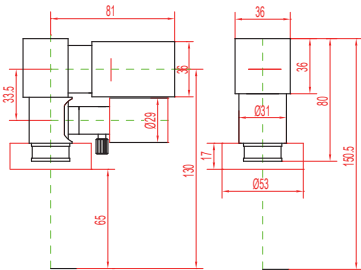

MTD12.5C-110

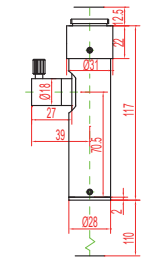

MTD12.5C-150S

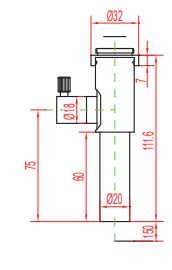

MTD12.5C-150

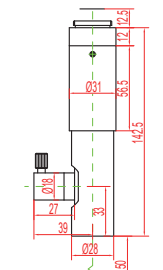

MTD12.5C-175

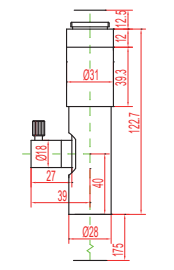

MTD12.5C-185SA

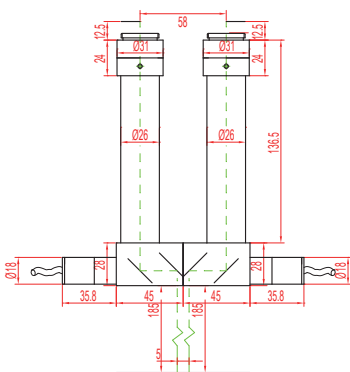

MTD12.5C-250

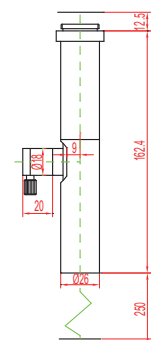

MTD12.5C-295

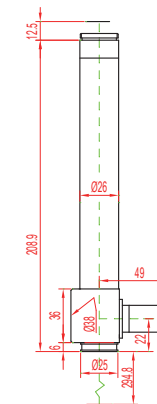

MTD15C-40RA

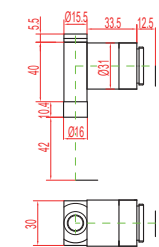

MTD15-90

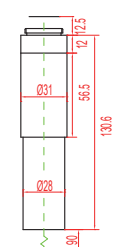

MTD15C-90

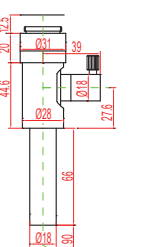

型号 Model	物镜倍数 Objective	工作距离 WD(mm)	总放大倍数 (Total Mag.)		视场 FOV(mm)	数值孔径 NA	景深 DOF	分辨率 Resolution				
			1/3"、9"	1/3"、17"								
MTD10C-180	1.0X	180	40X	72X	4.8X3.6	0.0273	1.47mm	12.3μm				
MTD10C-230		230				0.037	1.08mm	907μm				
MTD10C-473RA		473				0.0178	2.25mm	18.85				
MTD12.5C-60	1.25X	60	50X	90X	3.8X2.9	0.076	421μm	4.4μm				
MTD12.5C-70		70				0.067	477.6μm	5μm				
MTD12.5C-70RA		70				0.067	477.6μm	5μm				
MTD12.5C-110		110				0.065	571μm	6μm				
MTD12.5C-150S		150				0.041	780μm	8μm				
MTD12.5C-150		150				0.041	780μm	8μm				
MTD12.5C-175		175				0.036	889μm	9.2μm				
MTD12.5C-185SA		185				0.037	864.8μm	9.07μm				
MTD12.5C-250		245				0.034	941μm	9.6μm				
MTD12.5C-295		295				0.027	1.18mm	12.4μm				
MTD15C-40RA		1.5X				40	60X	108X	3.2X2.4	0.126	211.6μm	2.66μm
MTD15-90						90				0.06	444μm	5.6μm
MTD15C-90	90		0.06	444μm	5.6μm							

MTD15C-90RA

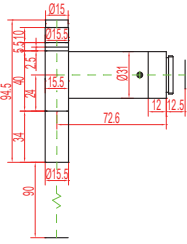

MTD15-100

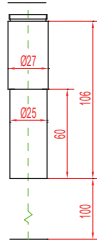

MTD15-150

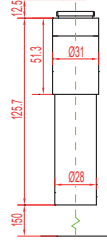

MTD15C-150

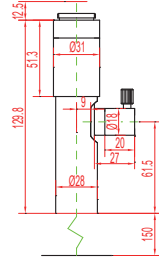

MTD15C-200SA

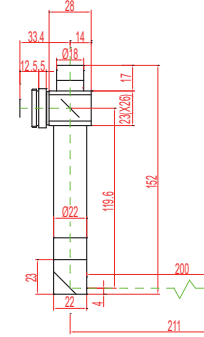

MTD15C-250

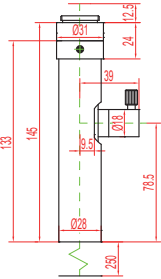

MTD20C-40RA

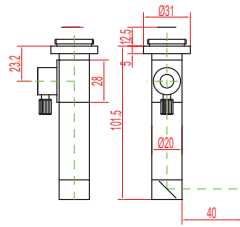

MTD20-50



MTD20C-55

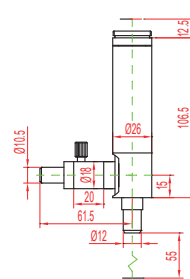

MTD20C-55RA

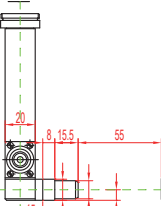

MTD20C-65

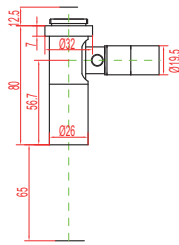

MTD20C-65S

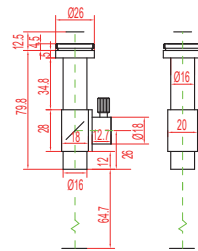

MTD20C-70

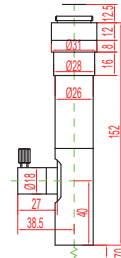

MTD20-90



MTD20-100S

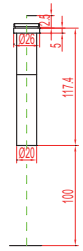

型号 Model	物镜倍数 Objective	工作距离 WD(mm)	总放大倍数 (Total Mag.)		视场 FOV(mm)	数值孔径 NA	景深 DOF	分辨率 Resolution
			1/3", 9"	1/3", 17"				
MTD15C-90RA	1.5X	90	60X	108X	3.2X2.4	0.06	444μm	5.6μm
MTD15-100		100				0.067	398μm	5μm
MTD15-115		115				0.07	381μm	4.8μm
MTD15-150		150				0.042	634.9μm	8.0μm
MTD15C-150		150				0.042	634.9μm	8.0μm
MTD15C-200SA		200				0.033	808.1μm	10.17μm
MTD15C-250	250	0.035	761.9μm	9.6μm				
MTD20C-40RA	2.0X	40	80X	144X	2.4X1.8	0.073	274μm	4.6μm
MTD20-50		50				0.12	166.7μm	2.8μm
MTD20C-55		55				0.079	253.2μm	4.2μm
MTD20C-55RA		55				0.079	253.2μm	4.2μm
MTD20C-65		65				0.073	274μm	4.6μm
MTD20C-65S		65				0.073	274μm	4.6μm
MTD20C-70		70				0.08	250μm	4.2μm
MTD20-90		90				0.073	274μm	4.6μm
MTD20-100S		100				0.063	317.5μm	5.3μm

MTD20C-110S

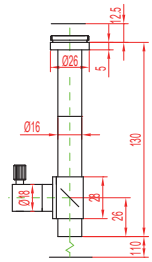

MTD20C-110

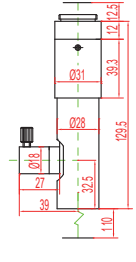

MTD20C-150

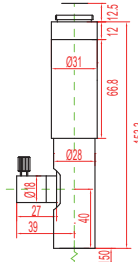

MTD20C-170

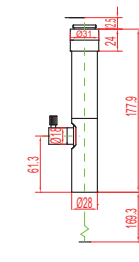

MTD20C-170A

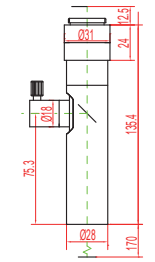

MTD20C-185SA

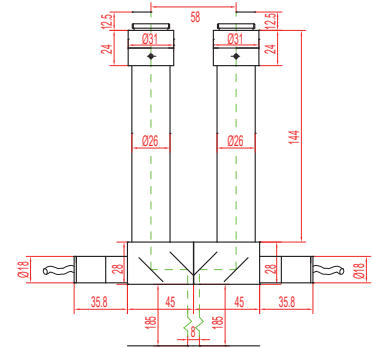

MTD25C-35

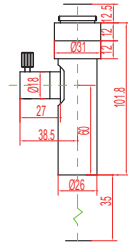

MTD25C-70

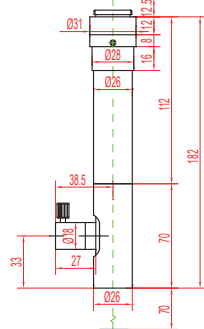

MTD25-100

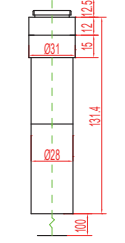

MTD25-100S

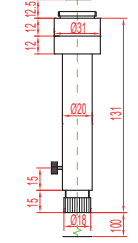

MTD25C-100

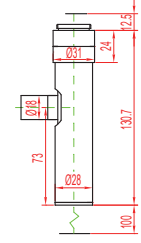

MTD25C-150

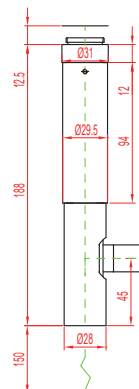

MTD25C-200SA

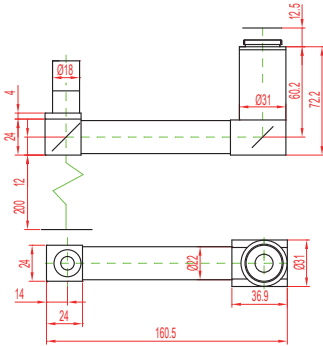

MTD30C-60

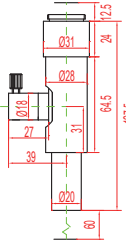

MTD30C-65

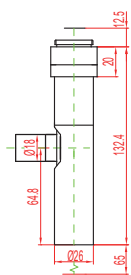

MTD30-70

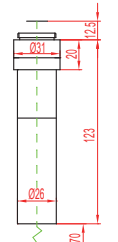

MTD30-99T (带微调)

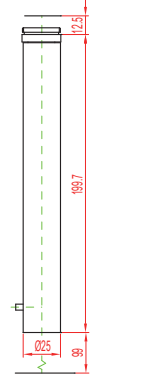

型号 Model	物镜倍数 Objective	工作距离 WD(mm)	总放大倍数 (Total Mag.)		视场 FOV(mm)	数值孔径 NA	景深 DOF	分辨率 Resolution
			1/3"、9"	1/3"、17"				
MTD20C-110S	2.0X	110	80X	144X	2.4X1.8	0.061	330μm	5.6μm
MTD20C-110		110				0.061	330μm	5.6μm
MTD20C-150		150				0.043	470μm	8μm
MTD20C-170		170				0.05	400μm	6.7μm
MTD20C-170A		170				0.05	400μm	6.7μm
MTD20C-185SA		185				0.037	540.5μm	9.1μm
MTD25C-35	2.5X	35	100X	180X	1.9X1.4	0.156	102.6μm	2.15μm
MTD25C-70		70				0.07	185μm	3.8μm
MTD25-100		100				0.07	229μm	4.8μm
MTD25-100S		100				0.07	229μm	4.8μm
MTD25C-100		100				0.07	229μm	4.8μm
MTD25-115S		115				0.07	229μm	4.8μm
MTD25C-150		150				0.058	275.9μm	5.8μm
MTD25C-200SA		200				0.038	421μm	8.8μm
MTD30C-60	3.0X	60	120X	216X	1.6X1.2X	0.07	190μm	4.7μm
MTD30C-65		65				0.075	178μm	4.5μm
MTD30-70		70				0.094	120μm	3.6μm
MTD30-99T (带微调)		99				0.067	199μm	5μm

单筒斜筒对刀显微镜
Tool-Setting Inclined Eyetube Microscope

※专为设备上精确对刀而设计
Special designed for precision tool-setting on equipment

双倍率视频光学系统
Double Magnification Video Optical Systems

※可实现两种视场大小，两种放大倍率同时观察同一物体
Can realize double Field of video & double Magnification while observing a objects



MTD30-90 / 42°

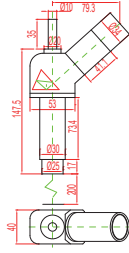

MTD10-200 / 42°



MTD(08-20)C-80

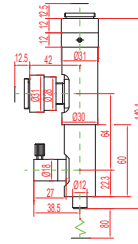

MTD(08-20)C-80

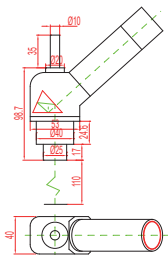

MTD20-110 / 42°

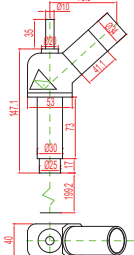

MTD20-200 / 42°

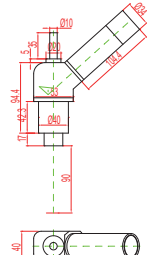

MTD30-90 / 42°

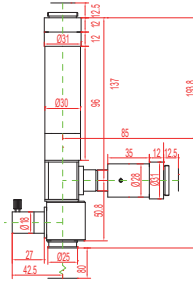

MTD(20-35)C-80

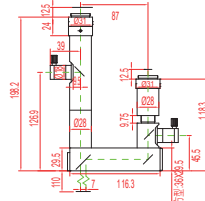

MTD(07-07)C-100

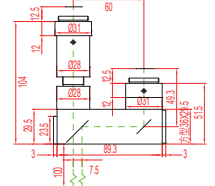

MTD(20-20)C-110

光学参数 Optical Specifications

● 单筒斜筒对刀显微镜 / Tool-Setting Inclined Eyetube Microscope

型号 / Model	物镜倍数 / Objective	工作距离 / WD(mm)	视场 / FOV(mm)	数值孔径 / NA	分辨率 / Resolution (μm)
MTD10-200/42°	1.0X	200	Φ23	0.037	8.9
MTD20-110/42°	2.0x	110	Φ11.5	0.062	5.4
MTD20-200/42°	2.0x	200	Φ11.5	0.043	7.8
MTD30-90/42°	3.0x	90	Φ7.7	0.075	4.5

● 双倍率视频光学系统 / Double Magnification Video Optical Systems

型号 Model	物镜倍数 Objective	工作距离 WD(mm)	总放大倍数 / Total Mag.		视场 FOV(mm)	数值孔径 NA	景深 DOF(μm)	分辨率 Resolution(μm)
			1/3"、9"	1/3"、17"				
MTD(08-20)C-80	0.8X~2.0X	80	32X~80X	48X~120X	6X4.5~2.4X1.8	0.061~0.062	800~320	5.5~5.4
MTD(20-35)C-80	2X~3.5X	80	80X~140X	120X~210X	2.4X1.8~1.4X1.0	0.076~0.082	250~140	4.6~4.1
MTD(07-07)-100	0.7X~0.7X	100	28X	42X	6.9X5.1 (中心距center distance 7.5mm)	0.051	1.12	6.58
MTD(20-20)C-110	2X~2X	110	80X	120X	2.4X1.8 (中心距center distance 7mm)	0.045	445	7.5

※本系列产品已获得国家专利授权，受相关国家法律法规保护。专利号：ZL 2011 2 0140265.3

This series have obtained national patents, and protected by related national laws and regulations. Patent number: ZL 2011 2 0140265.3